

A three-story brick house with a gabled roof. The front facade features two large bay windows on the upper floors, each with a small dormer window above it. The ground floor has a central entrance door and a window to the right. A satellite dish is mounted on the left side of the roof. The house is surrounded by a low brick wall and a wooden fence in the foreground.

255 Chichester Road, Bognor Regis PO21 5AH

£290,000 Freehold



3 Bedrooms



1 Bathroom



1 Reception Rooms

Sw

Sims Williams

Key Features

- No Forward Chain
- Semi-Detached
- Three Bedrooms
- Lounge/Diner
- Kitchen/Breakfast Room
- First Floor Bathroom
- Large Rear Garden
- Front Hardstanding
- Recently Redecorated

EPC Rating

Current = D

Potential = B

Council Tax Band

Band = B

Tenure - Freehold



Approximate Area = 997 sq ft / 92.6 sq m

Outbuilding = 97 sq ft / 9 sq m

Total = 1094 sq ft / 101.6 sq m

For identification only - Not to scale

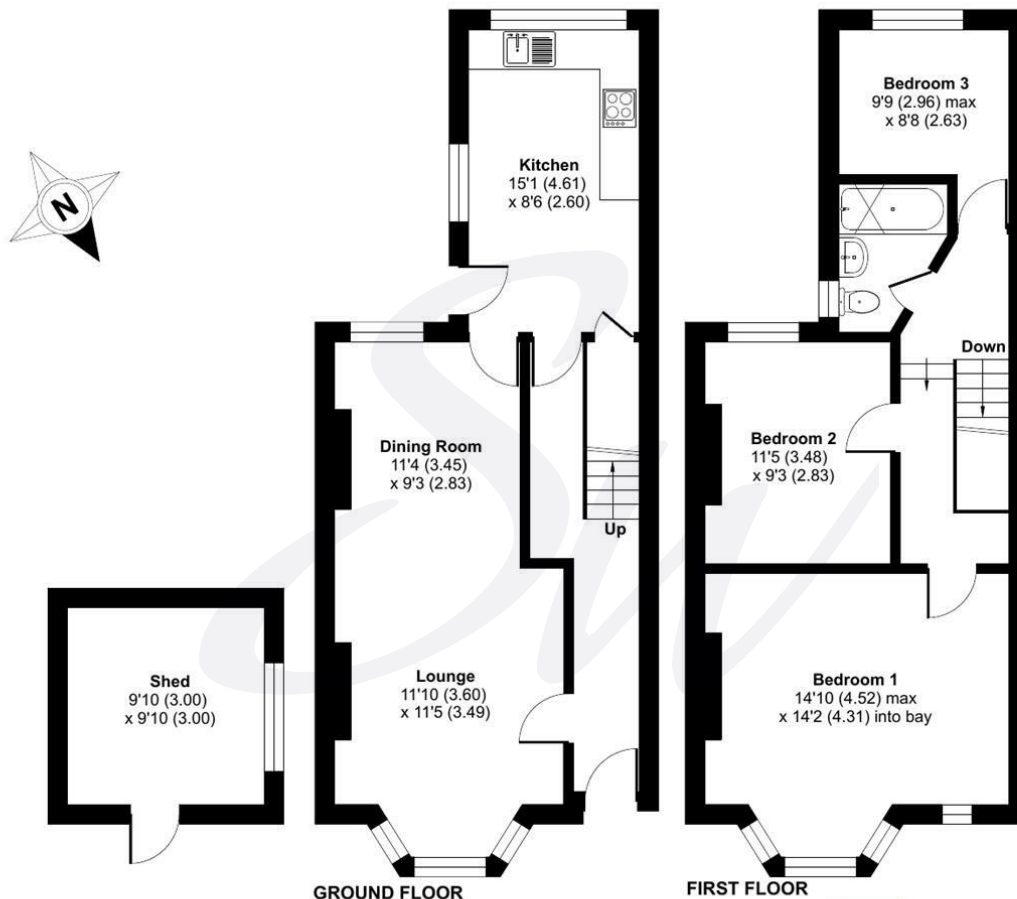

Floor plan produced in accordance with RICS Property Measurement 2nd Edition, incorporating International Property Measurement Standards (IPMS2 Residential). © nitchecom 2025. Produced for Sims Williams. REF: 1386872





simswilliams.co.uk

CHICHESTER

8-9 Southgate

Sales 01243 787868

Lettings 01243 836055

chichester@simswilliams.co.uk

WALBERTON

5 Maple Parade

Sales 01243 551368

Lettings 01243 836055

walberton@simswilliams.co.uk

ARUNDEL

8a High Street

Sales 01903 885678

Lettings 01903 881133

arundel@simswilliams.co.uk

BOGNOR REGIS

46 High Street

Sales 01243 862626

Lettings 01243 836055

bognor-regis@simswilliams.co.uk

Viewing Strictly by arrangement via the vendor's agent Sims Williams 01243 862626. These particulars are believed to be correct but their accuracy is not guaranteed and they do not form part of any contract.